

ZPFK

系列 series



REDUCER MODEL, SELECTION INSTRUCTIONS MODEL REPRESENTATION

● 减速机型号、选型说明型号表示

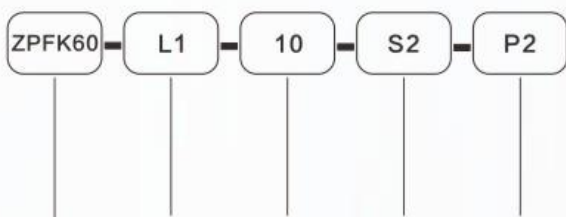

产品系列规格	级数	减数比	输出轴方式	精度等级
Product Series	Series	Ratio	output method	Precision
60	L1:一级	3	S2:单键轴	P2:标准
90	L2:二级	4	S1:光轴	P1:精密
120		5	K:空心单键轴	
		7		
		10		
		15		
		20		
		25		
		30		
		35		
		40		
			
		100		

SPEED REDUCER SELECTION INSTRUCTIONS

● 减速机选型须知

- 机种、型号、扭矩
 - 减速比或者出力轴转速
 - 工况及连接方式
 - 数量及安装的机械名称
 - 入力方式和入力转速
 - 电机厂牌型号或者法兰及电机轴尺寸
-
- model, model, polycarbonate
 - reduction ratio or output shaft axial
 - working conditions and connection methods
 - Quantity and installed machine name
 - Incoming mode and input transformation
 - Motor brand model or flange and motor shaft size

技术参数
Technical parameter

规格 Specifications		ZPFK60	ZPFK90	ZPFK120		
	级数 Series	比数 Gear ratio				
额定扭矩 T _N (Nm)	L1	3	22	96	155	
		4	34	122	216	
		5	35	122	223	
		7	27	95	164	
		10	16	56	90	
	L2	12	28	96	206	
		15	28	96	155	
		16	35	122	230	
		20	35	122	230	
		25	37	122	237	
		28	35	122	230	
		30	25	96	164	
		35	35	122	237	
		40	35	122	230	
		50	37	122	237	
		70	30	95	174	
		100	16	56	90	
		最大输出扭矩T _{2N} (Nm) The maximum output torque		2倍额定扭矩输出 2x rated torque output		
		满载效率(%) Full-load efficiency		L1≥96% L2≥92%		
平均使用寿命(h) Average service life		20000				
工作温度(℃) Working temperature		-20℃~+80℃				
防护等级 Level of protection		IP65				
安装方向 Installation direction		任意方向 Arbitrary direction				
重量(Kg) Weight (Kg)	L1	1.8	5.1	10.6		
	L2	2.1	6.05	12.7		

ZF
PL
PNF
PWE
ZPF
ZPL
PFK
ZPFK
ZPNF
ZPWE
PFC 29F
42-PFS
ZPFS150
SHD
Z260
ZT290
ZK90

技术参数 Technical parameter

规格 Specifications			ZPFK60	ZPFK90	ZPFK120		
最大输入转速 n1N Maximum input speed			rpm	8000	6000	4800	
额定输入转速 n1B Rated input speed			rpm	4000	3500	3000	
最大容许径向力 F2rB The maximum allowable radial force			N	320	680	1730	
最大容许轴向力 F2aB The maximum allowable axial force			N	260	620	1270	
抗扭刚性 Torsional rigidity			Nm/arcmin	2	6.2	11.1	
噪音值 Noise value			dB	≤58	≤60	≤65	
Return stroke clearance 回程间隙	P1	L1	arcmin	≤8	≤8	≤8	
		L2	arcmin	≤12	≤12	≤12	
	P2	L1	arcmin	≤16	≤16	≤16	
		L2	arcmin	≤20	≤20	≤20	
	Moment of inertia 转动惯量	L1	3	Kg.cm ²	0.28	1.55	7.3
			4	Kg.cm ²	0.27	1.5	7
			5	Kg.cm ²	0.27	1.49	6.97
			7	Kg.cm ²	0.25	1.24	6.26
			10	Kg.cm ²	0.25	1.24	6.24
		L2	12	Kg.cm ²	0.27	1.33	6.92
15			Kg.cm ²	0.26	1.31	6.9	
16			Kg.cm ²	0.27	1.3	6.74	
20			Kg.cm ²	0.27	1.28	6.67	
25			Kg.cm ²	0.27	1.28	6.67	
L2	28	Kg.cm ²	0.27	1.27	6.66		
	30	Kg.cm ²	0.25	1.27	6.66		
	35	Kg.cm ²	0.25	1.27	6.65		
	40	Kg.cm ²	0.27	1.27	6.65		
	50	Kg.cm ²	0.22	1.1	6.3		
L2	70	Kg.cm ²	0.22	1.1	6.3		
	100	Kg.cm ²	0.22	1.1	6.3		

ZPFK

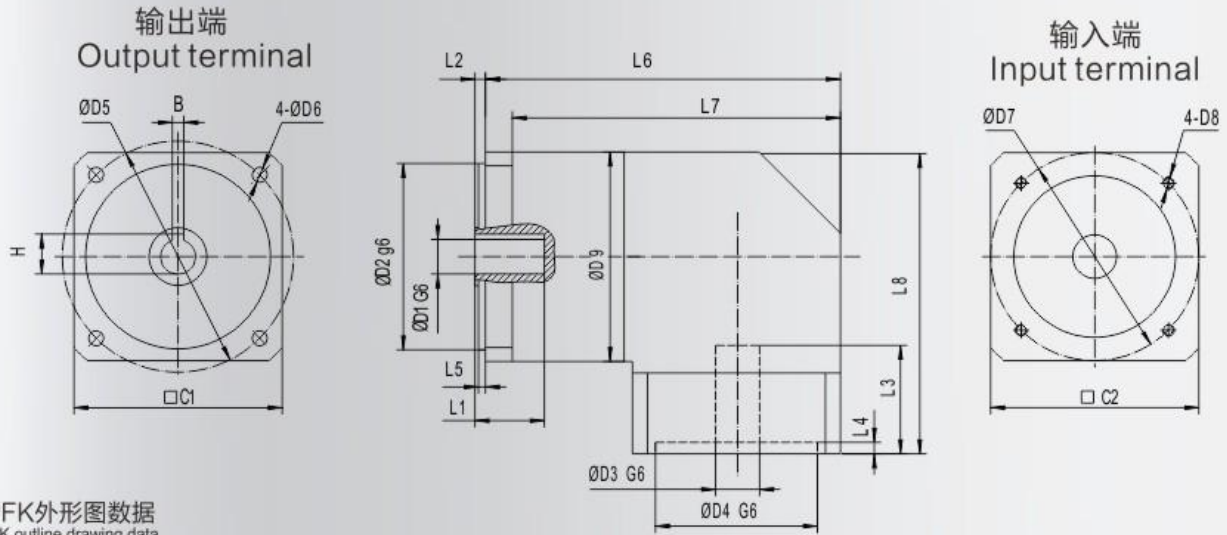

ZPFK外形图数据
ZPFK outline drawing data

级数	规格	D1	D2	D3	D4	D5	D6	D7	D8	D9	L1	L2	L3	L4	L5	L6	L7	L8	C1	C2	B	H
单级 L1	ZPFK60	10	50	14	50	70	5.5	70	M4	60	20	4	31.5	5	3	111.5	101.5	100.5	60	60	3	11.4
		10	50	11	50	70	5.5	70	M4	60	20	4	31.5	5	3	111.5	101.5	100.5	60	60	3	11.4
		10	50	8	38.1	70	5.5	66.7	M4	60	20	4	31.5	5	3	111.5	101.5	100.5	60	60	3	11.4
		10	50	8	36	70	5.5	70.7	M4	60	20	4	31.5	5	3	111.5	101.5	100.5	60	60	3	11.4
	ZPFK90	15	80	19	70	100	6.5	90	M5	90	30	4.5	47	5	3	153.5	141.5	130	90	90	5	17.3
		15	80	16	80	100	6.5	100	M5	90	30	4.5	47	5	3	153.5	141.5	130	90	90	5	17.3
		15	80	14	73	100	6.5	98.43	M5	90	30	4.5	47	5	3	153.5	141.5	130	90	90	5	17.3
		15	80	14	60	100	6.5	98.43	M5	90	30	4.5	47	5	3	153.5	141.5	130	90	90	5	17.3
	ZPFK120	20	110	22	110	130	8.5	145	M8	120	40	5.5	59.5	8	4	191	176	160.8	120	120	6	22.8
		20	110	24	110	130	8.5	145	M8	120	40	5.5	59.5	8	4	191	176	160.8	120	120	6	22.8
		20	110	19	95	130	8.5	115	M8	120	40	5.5	59.5	8	4	191	176	160.8	120	120	6	22.8
		20	110	19	95	130	8.5	130	M8	120	40	5.5	59.5	8	4	191	176	160.8	120	120	6	22.8
双级 L2	ZPFK60	10	50	14	50	70	5.5	70	M4	60	20	4	31.5	5	3	127.5	117.5	100.5	60	60	3	11.4
		10	50	11	50	70	5.5	70	M4	60	20	4	31.5	5	3	127.5	117.5	100.5	60	60	3	11.4
		10	50	8	38.1	70	5.5	66.7	M4	60	20	4	31.5	5	3	127.5	117.5	100.5	60	60	3	11.4
		10	50	8	36	70	5.5	70.7	M4	60	20	4	31.5	5	3	127.5	117.5	100.5	60	60	3	11.4
	ZPFK90	15	80	19	70	100	6.5	90	M5	90	30	4.5	47	5	3	177.5	165.5	130	90	90	5	17.3
		15	80	16	80	100	6.5	100	M5	90	30	4.5	47	5	3	177.5	165.5	130	90	90	5	17.3
		15	80	14	73	100	6.5	98.43	M5	90	30	4.5	47	5	3	177.5	165.5	130	90	90	5	17.3
		15	80	14	60	100	6.5	98.43	M5	90	30	4.5	47	5	3	177.5	165.5	130	90	90	5	17.3
	ZPFK120	20	110	22	110	130	8.5	145	M8	120	40	5.5	59.5	8	4	222	207	160.8	120	120	6	22.8
		20	110	24	110	130	8.5	145	M8	120	40	5.5	59.5	8	4	222	207	160.8	120	120	6	22.8
		20	110	19	95	130	8.5	115	M8	120	40	5.5	59.5	8	4	222	207	160.8	120	120	6	22.8
		20	110	19	95	130	8.5	130	M8	120	40	5.5	59.5	8	4	222	207	160.8	120	120	6	22.8
ZPFK120	20	110	19	85	130	8.5	132	M8	120	40	5.5	59.5	8	4	222	207	160.8	120	120	6	22.8	

- ZF
- PL
- PNF
- PWE
- ZPF
- ZPL
- PFK
- ZPFK
- ZPNF
- ZPWE
- PFK-ZPF
- ZPFS150
- SHD
- ZZ60
- ZTZ90
- ZK90